

T24N-R19E

CRAIG COUNTY, OKLAHOMA

1

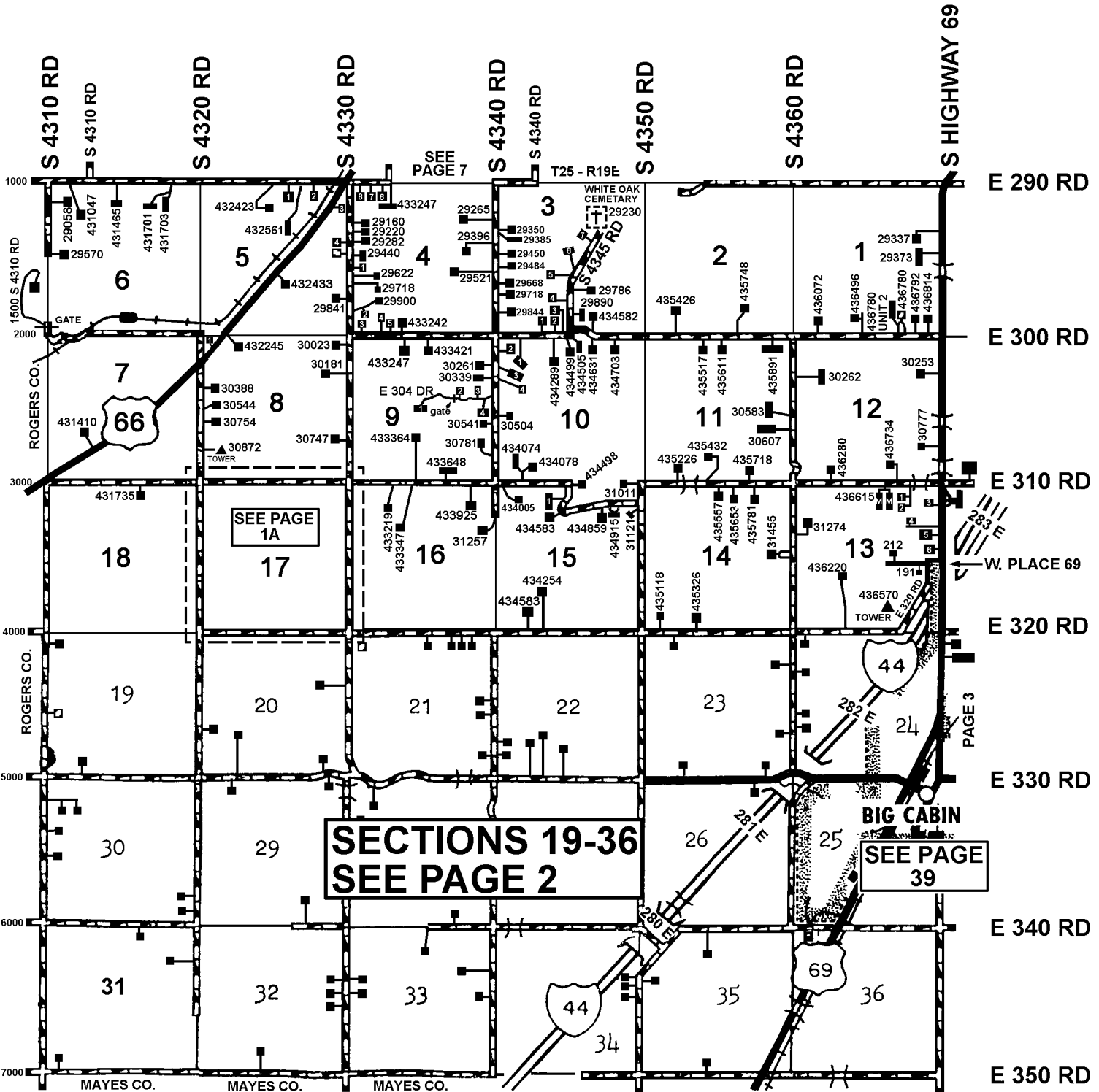

- SECTION 3**
1. 434274 5. 29673
2. 434318 6. 29697
3. 434350 7. 29363
4. 29847
- SECTION 4**
1. 29446 5. 433214
2. 29912 6. 433149
3. 433044 7. 433137
4. 433118 8. 433083
- SECTION 5**
1. 432555 3. 432741
2. 432759 4. 29303

- SECTION 8**
1. 432146
- SECTION 9**
1. 433651
2. 433870
3. 433944
4. 433969
- SECTION 10**
1. 434053
2. 30026
3. 30256
4. 30348

- SECTION 13**
1. 436803
2. 436809
3. 31209
4. 31243
5. 31303
6. 31485
- SECTION 15**
1. 434503

10-28-1994
REVISED 11-4-2022
CRAIG COUNTY E-911
M = MARIJUANA GROW FACILITY

