

T24N-R21E

CRAIG COUNTY, OKLAHOMA

4

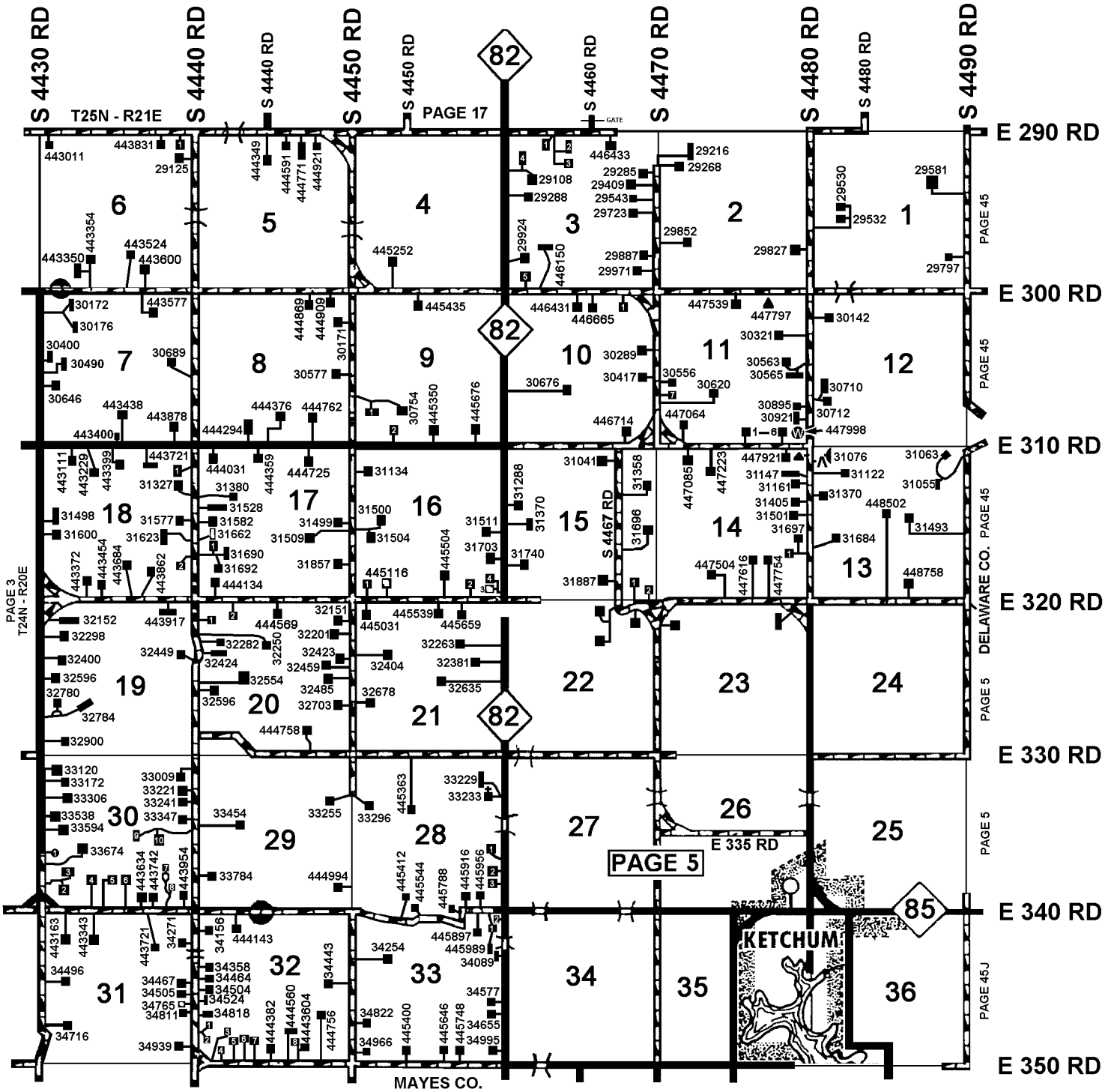

- SECTION 3**
 1. 446349
 2. 446355
 3. 446359
 4. 29104
 5. 446110

- SECTION 6**
 1. 443897

- SECTION 9**
 1. 30754, UNIT 2
 2. 445136

- SECTION 10**
 1. 446799

- SECTION 11**
 1. 447486
 2. 447624
 3. 447664
 4. 447840
 5. 447860
 6. 447864
 7. 30584

- SECTION 14**
 1. 31697, UNIT 2

- SECTION 15**
 1. 446862
 2. 446998

- SECTION 16**
 1. 445030
 2. 445742
 3. 31913
 4. 31911

- SECTION 17**
 1. 31688

- SECTION 18**
 1. 31051
 2. 31699

- SECTION 20**
 1. 32188
 2. 44241

- SECTION 28**
 1. 33711
 2. 33925
 3. 33955

- SECTION 30**
 1. 33667
 2. 33858
 3. 3386
 4. 443334
 5. 443394
 6. 443488
 7. 443844
 8. 443846
 9. 33473
 10. 33473

- SECTION 32**
 1. 34846
 2. 34850
 3. 444078
 4. 444220
 5. 444268
 6. 444310
 7. 444332
 8. 444586

- SECTION 3**
 1. 34023
 2. 445987

2-10-1994
 REVISED 6-12-2023
 CRAIG COUNTY E-911

