

T25N - R20E

SECTION 15

CRAIG COUNTY, OKLAHOMA

7-22-2008

HEARTSWORTH  
HOUSE

9G2

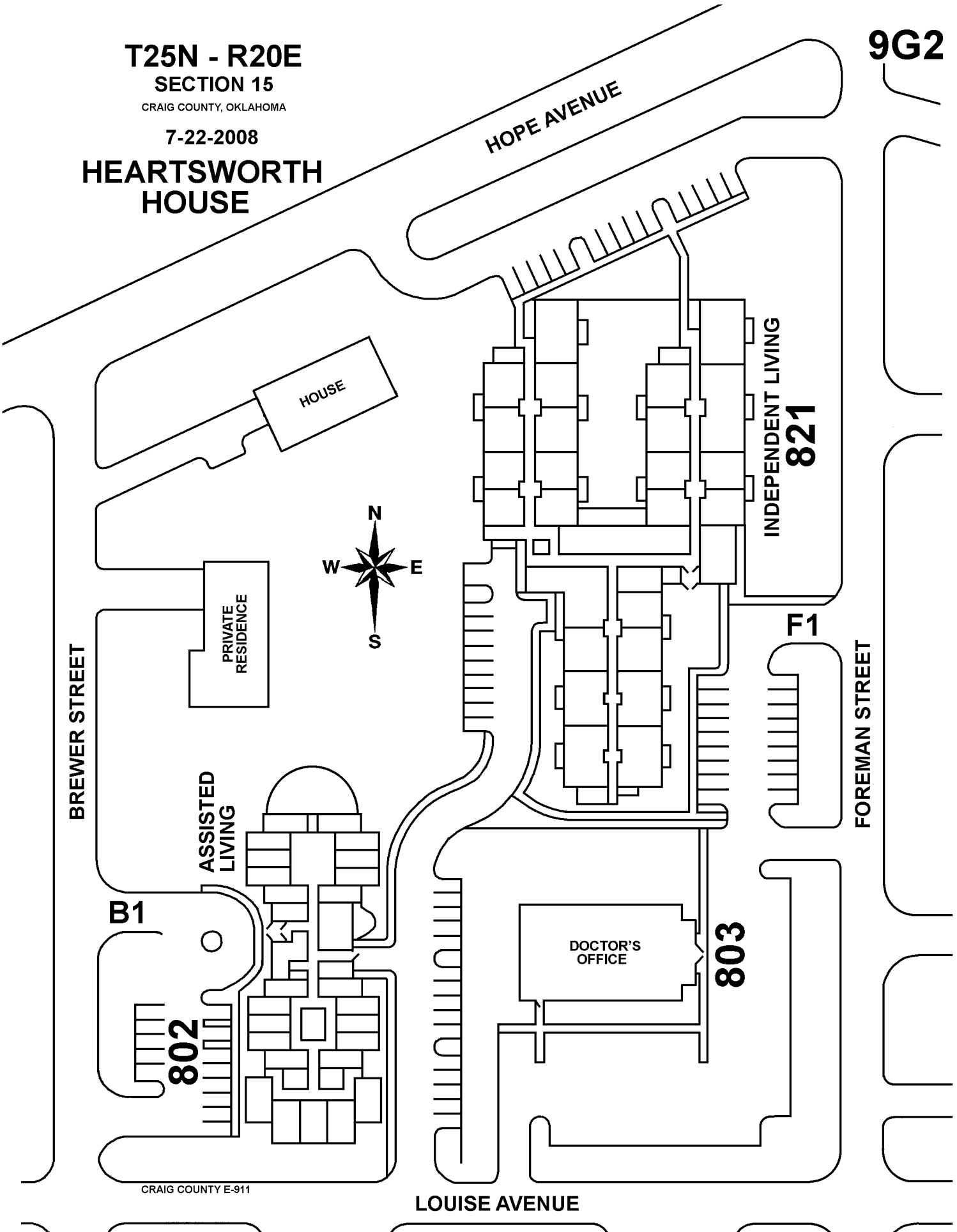

BREWER STREET

HOUSE



PRIVATE  
RESIDENCE

ASSISTED  
LIVING

B1

802

DOCTOR'S  
OFFICE

803

INDEPENDENT LIVING  
821

F1

FOREMAN STREET

LOUISE AVENUE

CRAIG COUNTY E-911