

T24N - R22E

45B4

SECTION 32

DELAWARE COUNTY, OKLAHOMA

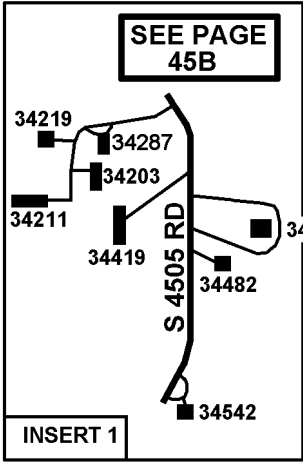
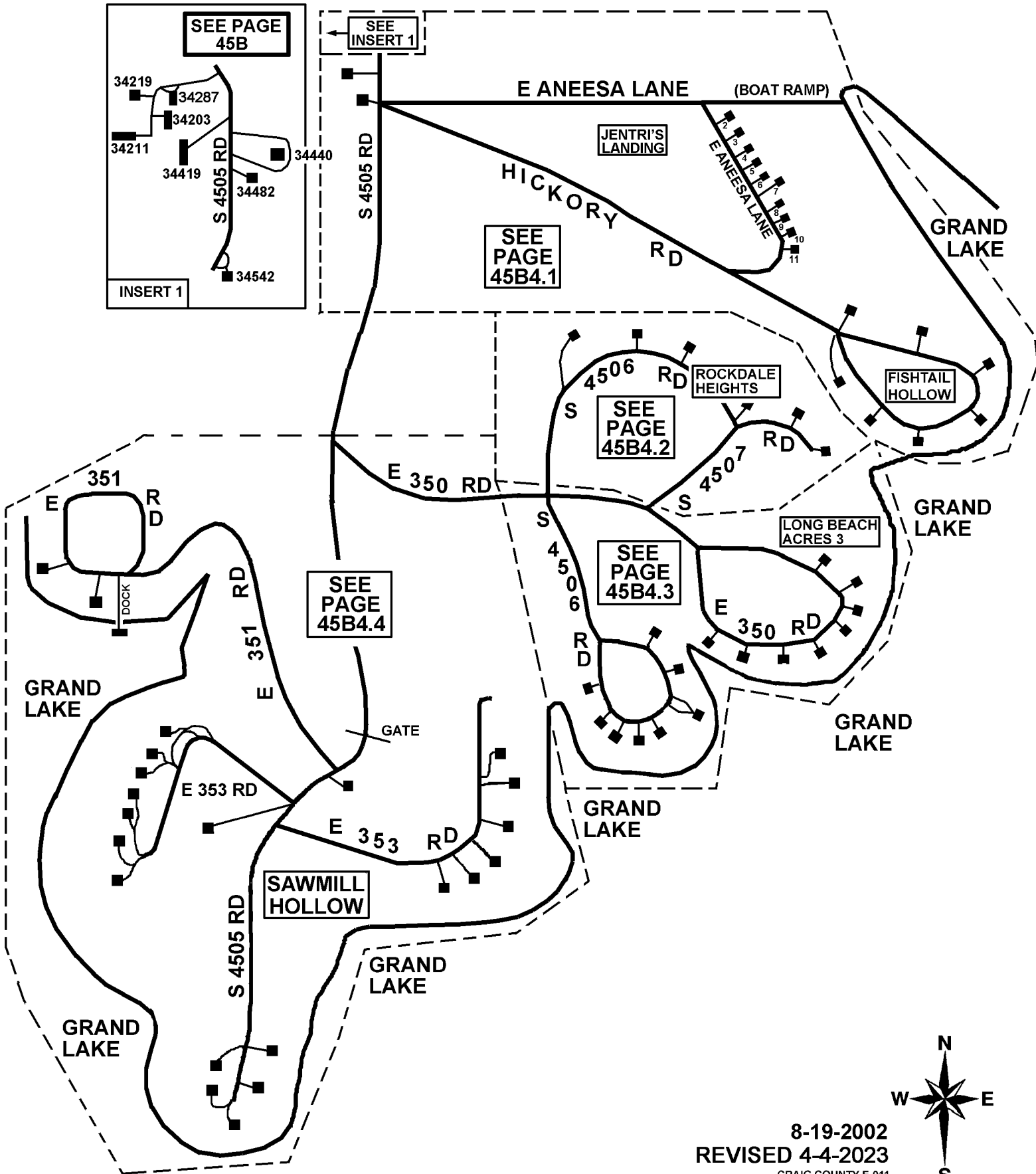

SEE PAGE 45B4.1

SEE PAGE 45B4.2

SEE PAGE 45B4.3

SEE PAGE 45B4.4

8-19-2002
REVISED 4-4-2023
CRAIG COUNTY E-911

