

T25N R19E  
 SECTIONS 4-9, 16-18  
 CRAIG COUNTY, OKLAHOMA

07A

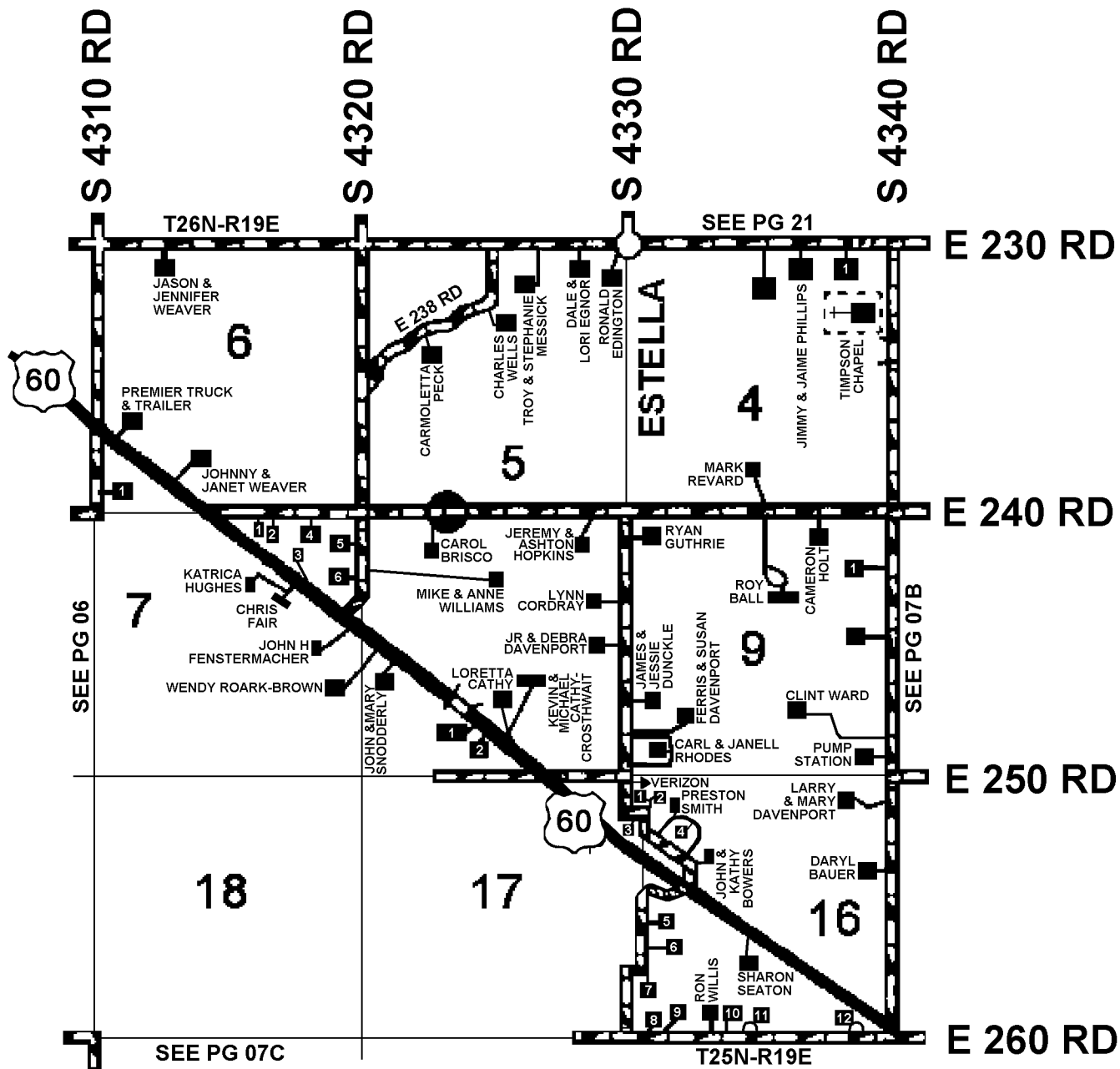

- SECTION 4
- 1. DEBBIE THOMAS
- SECTION 6
- 1. JUSTIN & JENNIFER TURNER
- SECTION 7
- 1. VACANT
- 2. VACANT
- 3. US CELULAR TOWER
- 4. JOHN & TINA WHITE
- 5. JUAN & SANDRA AMADOR
- 6. RANDY & BECKY LEE
- SECTION 8
- 1. VACANT
- 2. JACK & JANE HOGUE
- SECTION 9
- 1. RAYMOND & VELMA HOLT

12-2-2010  
 REVISED 3-6-2023  
 CRAIG COUNTY E-911

NOTE: NAMES MAY NOT BE CURRENT

