

T25N R19E
 SECTIONS 19-21, 28-33
 CRAIG COUNTY, OKLAHOMA

7C

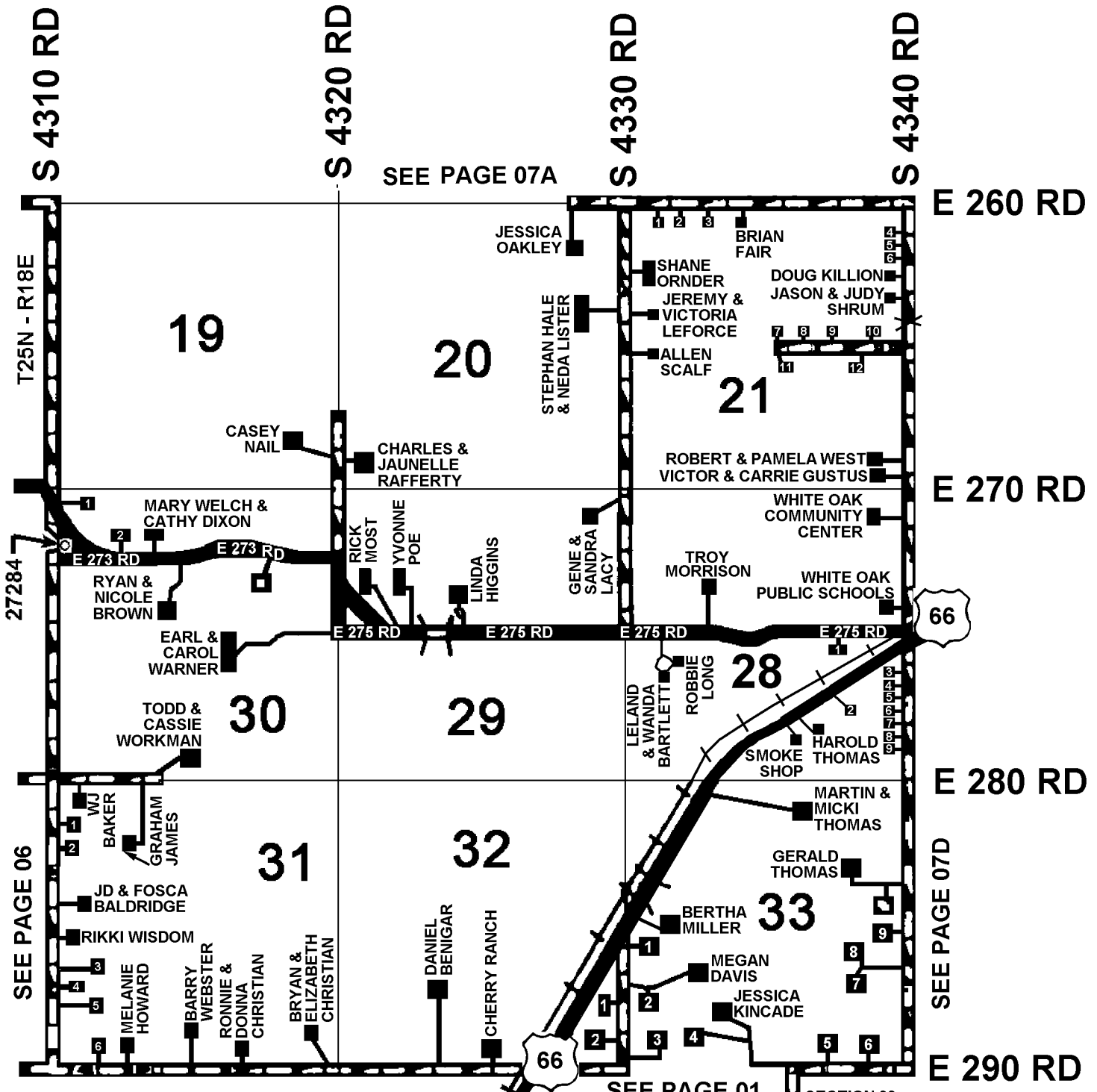

- SECTION 21
1. DAVID & PATTY KILLION
 2. MICHAEL & ANDREA FOUST
 3. BOBBIE FAIR
 4. LOYAL SHAWNEE TRIBE BLDG
 5. JANEY LIVINGSTON
 6. JUDY LIVINGSTON
 7. RONNIE & CATHERINE YOCHAM
 8. CLAUDIA BROOKS
 9. TIMOTHY & ROBIN FLEMING

- SECTION 21
10. LLOYD McCOLEY
 11. RICK & ROXANNA ZIPP
 12. ANN SULIVAN-GEYER
- SECTION 28
1. BRETT SHRIVER
 2. ROBERT & BRENDA MARKLE
 3. STEVEN HANES
 4. JEAN NEWCOMB
 5. VACANT
 6. TERRY RAMSEY

- SECTION 28
7. VACANT
 8. JOY STROYICK
 9. LINDA LEE
- SECTION 30
1. BRYAN & CLAIRE WELCH
 2. JOHN & IVY WELCH
- SECTION 31
1. AUSTIN ICE & ALLISON MILLER
 2. EDDIE HEARD

- SECTION 31
3. JOE INGERSOLL
 4. LOUI & TERI NEL
 5. HEATHER LINDERSMITH
 6. CALVIN & PRISCILLA WILKINS
- SECTION 32
1. DARIN & KATHY MILLER
 2. TOM & TAMMY ALLARD

- SECTION 33
1. PAUL & KAREN SPRADLING
 2. ROGER & MAE DAVIS
 3. BUCK DAVIS
 4. ROGER & DOLORES TUNE
 5. AUDREY ALLEN
 6. BILL ALLARD
 7. PAUL & JOYCE KELSO
 8. IVAN HALE
 9. BIANCA KIRKENDAL



9-14-1994
 REVISED 6-6-2023
 CRAIG COUNTY E-911