

T25N - R20E

SECTION 15

CRAIG COUNTY, OKLAHOMA

7-22-2008

HEARTSWORTH
HOUSE

9G2

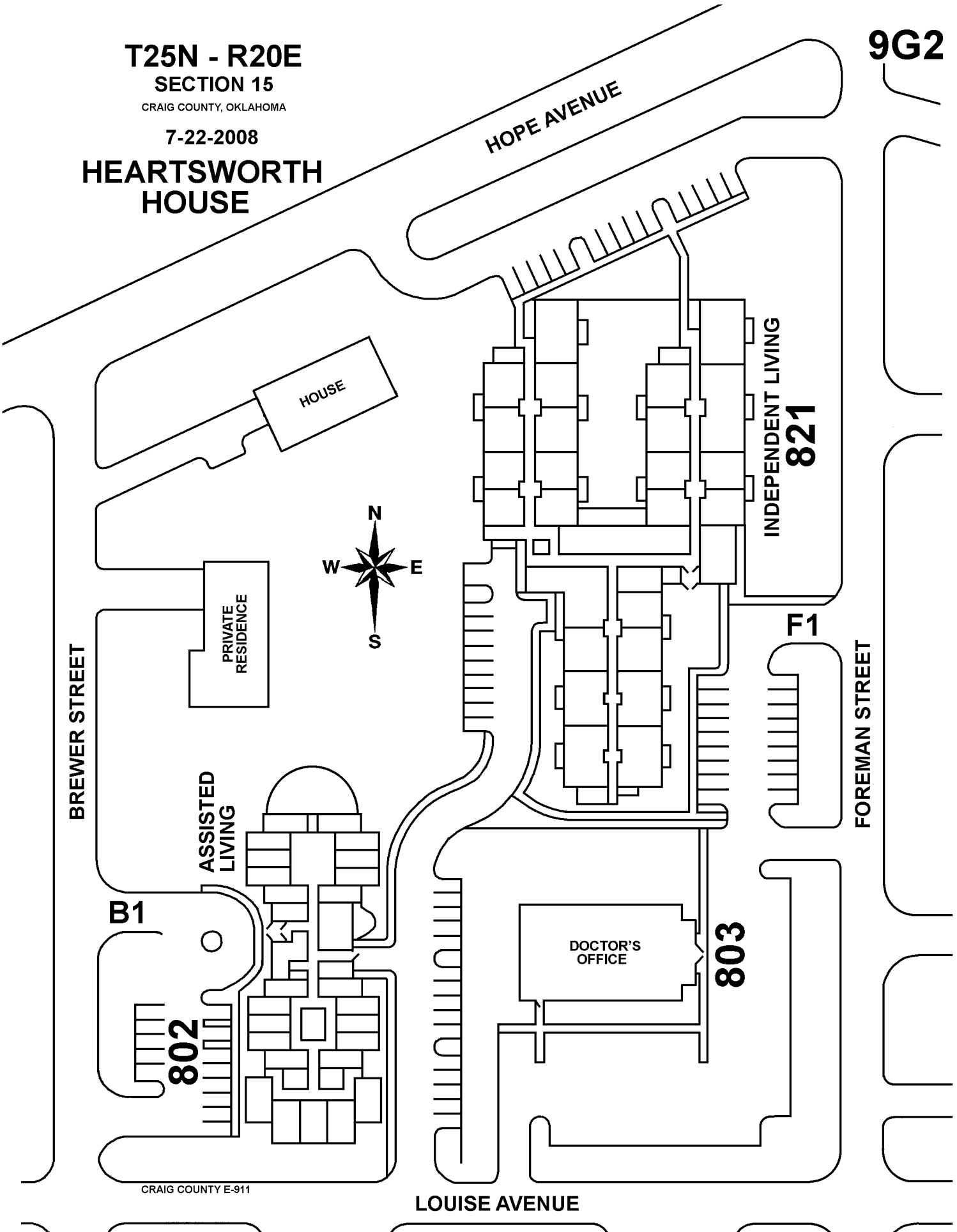

BREWER STREET

HOPE AVENUE

HOUSE

PRIVATE
RESIDENCE



INDEPENDENT LIVING
821

F1

FOREMAN STREET

ASSISTED
LIVING

B1

802

DOCTOR'S
OFFICE

803

LOUISE AVENUE

CRAIG COUNTY E-911