

T27N - R20E
CRAIG COUNTY, OKLAHOMA

27

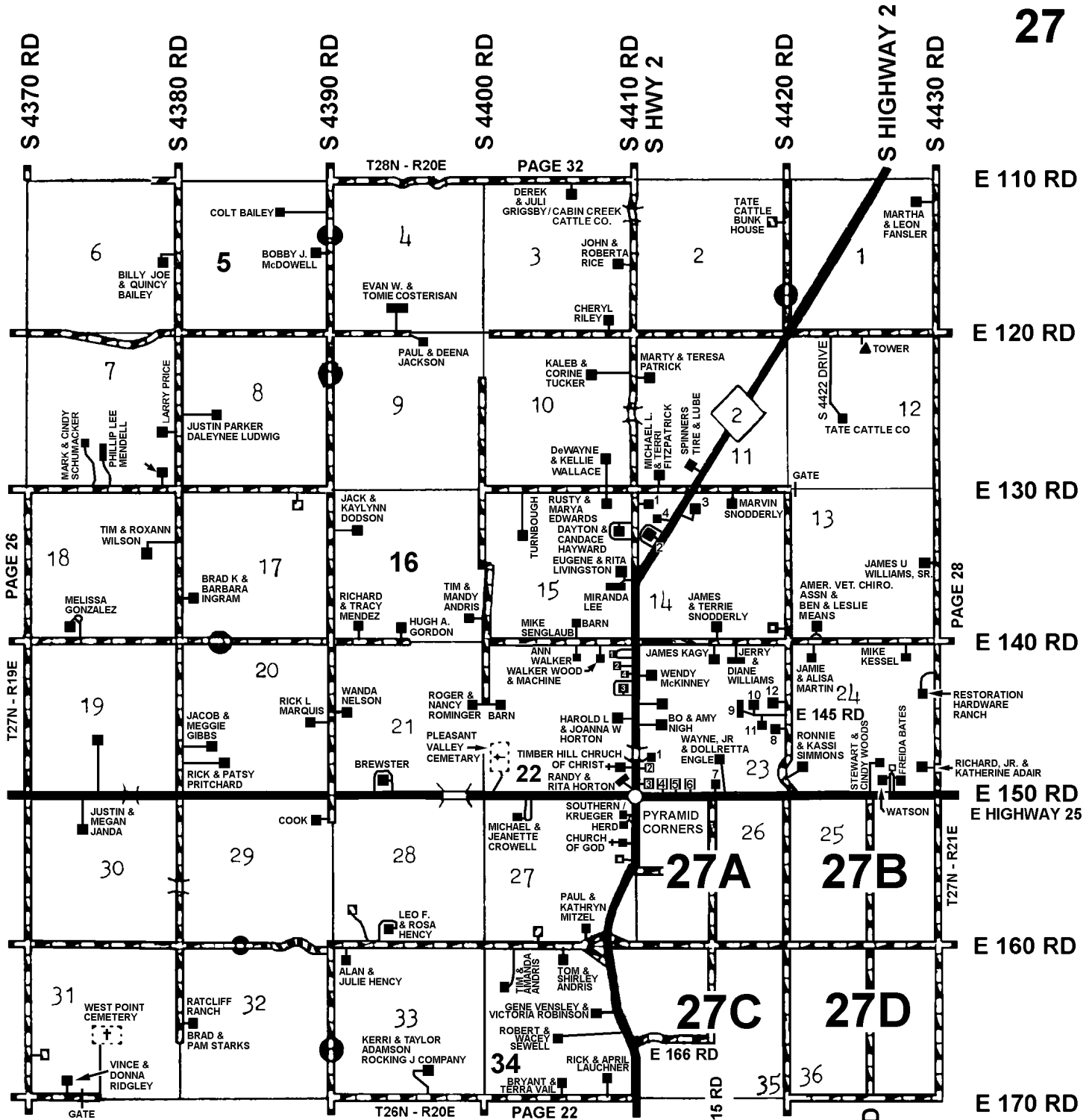

- SECTION 14**
1. GUTHRIE MURRAY & TIMOTHY LIVINGSTON
 2. JOHNNIE & BETSY HURST
 3. KEVIN & SHEENA REECE
 4. KEITH & MARY HURST
- SECTION 22**
1. CORNERSTONE FAITH MISSION
 2. DON & ANITA FROST
 3. RANDY & MICHELLE MCGILL
 4. TRENTON & KAITLYNN HERD

- SECTION 23**
1. THOMAS & VICKIE HERRIN
 2. JAMES VICKERY
 3. FARMERS MKT / CHRIS' AUTO DETAIL SHOP
 4. BRANDON & BRANDI BREWSTER
 5. SANDRA K GRUE
 6. CLARENCE R. & GLORIA FAIR
 7. CAROL SIMPSON
 8. TANER COLBY
 9. VACANT TRAILER
 10. LARRY JOE & ARINDA WILLIAMS
 11. KRystal ARINDA WILLIAMS
 12. RANSEN HORTON

5-12-1995
REVISED 5-19-2023
CRAIG COUNTY E-911
NOTE: NAMES MAY NOT BE CURRENT

