

S 4430 RD

S 4440 RD

S 4450 RD

S 4460 RD

S 4470 RD

S 4480 RD  
S 480 RD

S 4490 RD  
S 490 RD

28

T27N - R21E

T28N - R21E PAGE 33

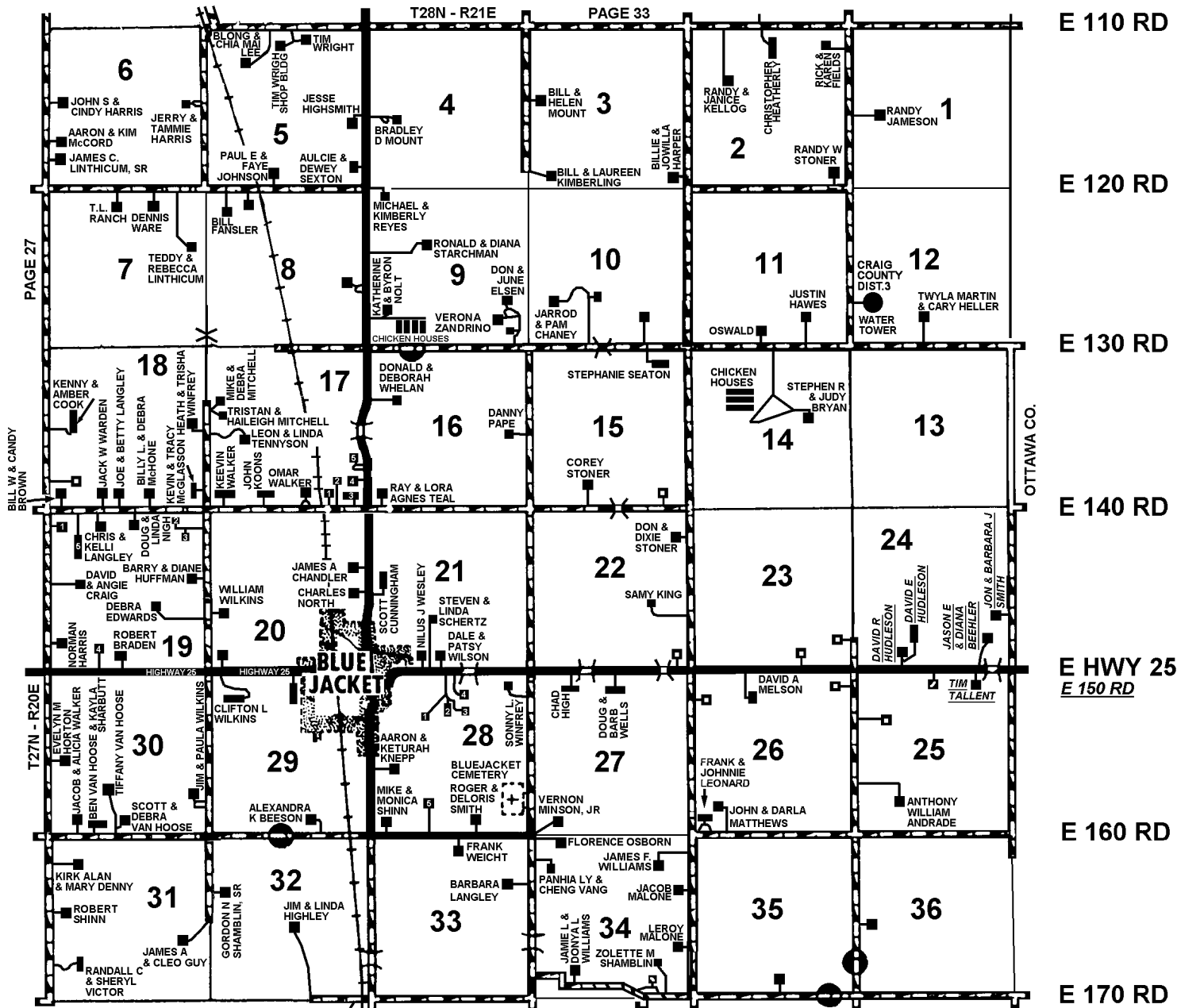

- SECTION 17
1. AT&T
  2. LEGACYMEE FARMS, LLC
  - 3.
  4. MEE CHANG
  5. DONALD & LANEITA CHAMBERLAIN

- SECTION 28
1. MARC & JOELLA SHAFFER
  2. COLTON SMITH & DEJA WILSON
  3. TERRY & CRYSTAL V CHAMBERLAIN
  4. TREY L & SHEEN M DAVENPORT
  5. PAUL T & DELORES AYRES

- SECTION 19
1. GENE L WINDLE
  2. FIRST CLASS PUPPIES
  3. DAVID L & LYNN BROWN
  4. DON & TONI FLOYD
  5. LAKE & SIDNEY COKER

CRAIG COUNTY, OKLAHOMA

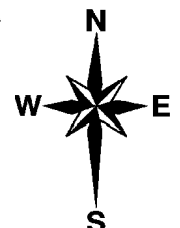

7-3-1994  
 REVISED 4-24-2023  
 CRAIG COUNTY E-911

NOTES:  
 \*NAMES MAY NOT BE CURRENT  
 \*ROADS WITH UNDERLINES ARE OTTAWA COUNTY E-911 NUMBERS