

S HWY 2  
S 4440 RD

S 4450 RD

SW GROVE  
S 4460 RD

S 4465 RD

S 4470 RD

S 4480 RD

S 4490 RD

38

### T29N - R21E

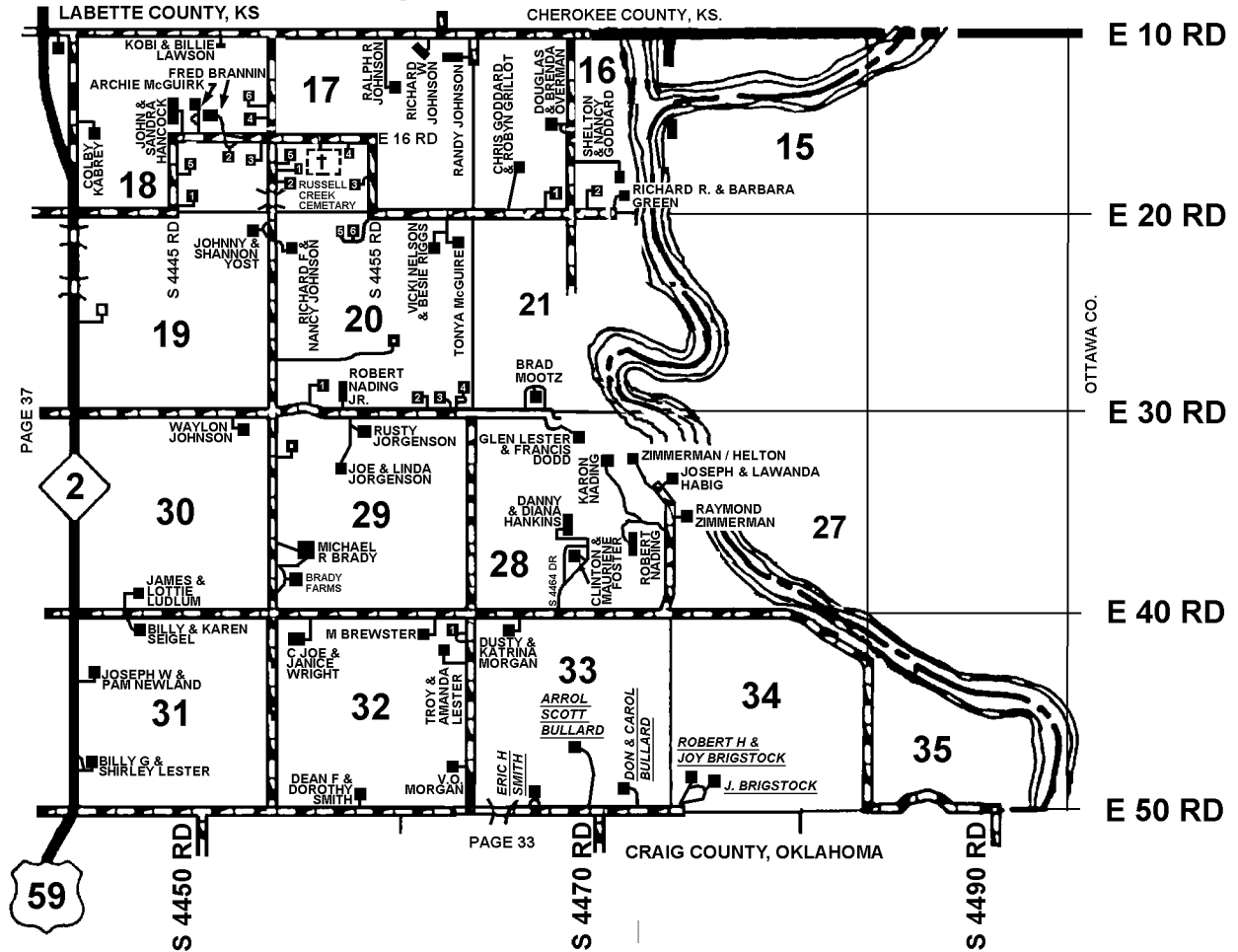

- SECTION 16**  
 1. FRED JR & LYNETTE GODDARD  
 2. MICHAEL MUELLER

- SECTION 17**  
 1. MELISSA DUEDE  
 2. HENRY & JEANIE STEPHENSON  
 3. DALE TULLIS  
 4. MATT BROWN & AMANDA McDONALD  
 5. EDDIE LAMAR McGLAMORY

- SECTION 18**  
 1. KENDRA DARBY  
 2. CHARLES R ALLEN  
 3. RICHARD A FRAKER  
 4. TIMOTHY WELCH  
 5. ANDREW & REGINA HANSON  
 6. ROBERT & TONI OVERMAN

- SECTION 20**  
 1. DAVID J THOMAS  
 2. MICHELLE ORLOVETZ  
 3. ROCKY W. & MELODY RUPERT  
 4. KEVIN B & TAMMY SMITH  
 5. LIGHTHOUSE COMMUNITY CHURCH  
 6. LINDA HEMBREE

- SECTION 32**  
 1. RICK & GLORIA STILLS

2-1-1998  
REVISED 8-31-2022

CRAIG COUNTY E-911  
NOTE: NAMES MAY NOT BE CURRENT