

T23N - R20E SECTIONS 14, 23 & 26

MAYES COUNTY, OKLAHOMA

43A

1. JOHN OBNRADER
2. JACOB & KATHERINE LITTLEFIELD
3. MATTHEW SIMMONS
- 4.

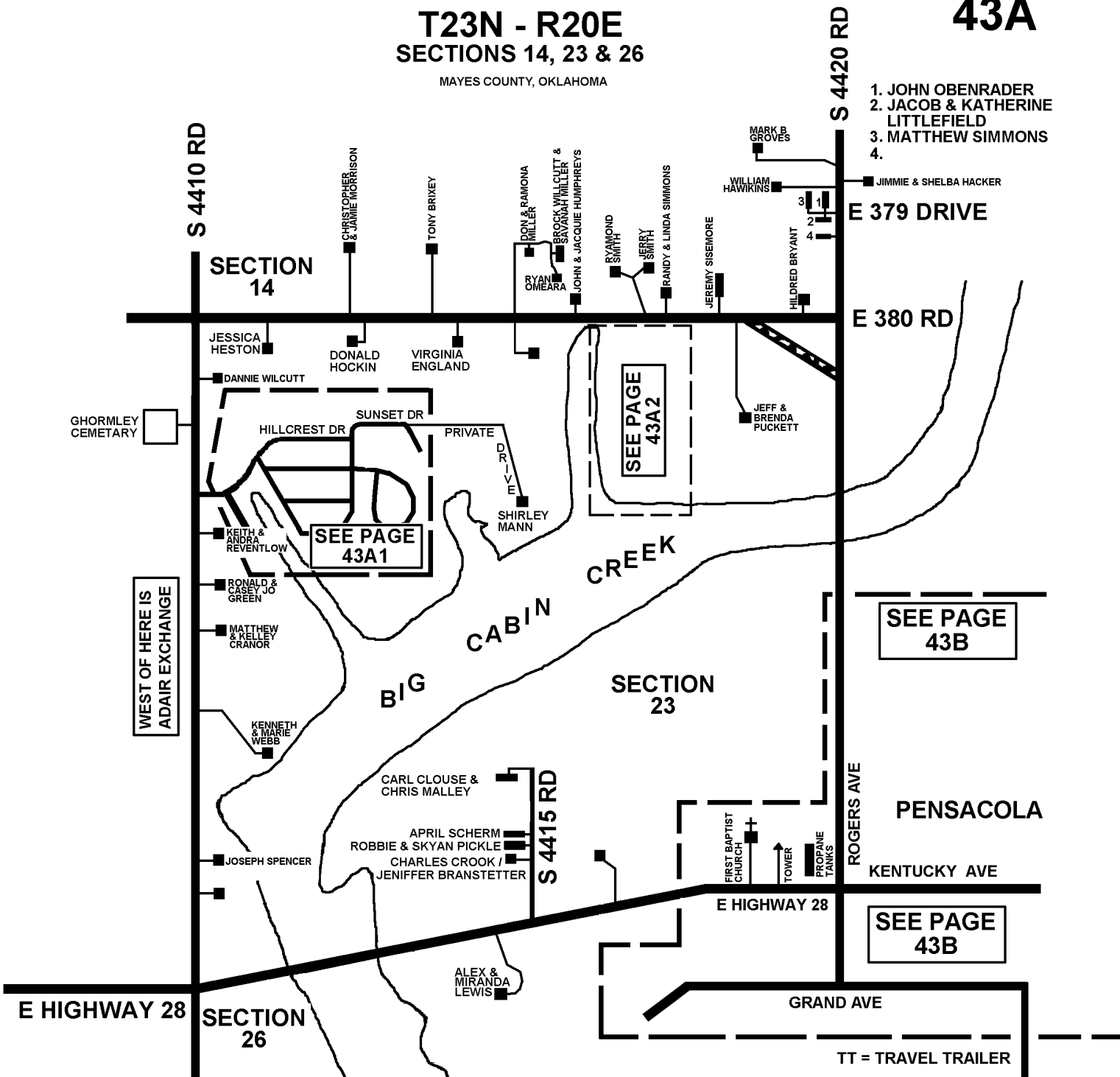

NOTE: NAMES MAY NOT BE CURRENT



1-3-2004
REVISED 5-30-2023
CRAIG COUNTY E-911