

G.G. GILES PORT PLEASURE
COLONY COVE
WILLOW PARK SUB

44F3

T24N - R21E
SECTION 35
CRAIG COUNTY, OKLAHOMA

T23N - R21E
SECTION 02
MAYES COUNTY, OKLAHOMA

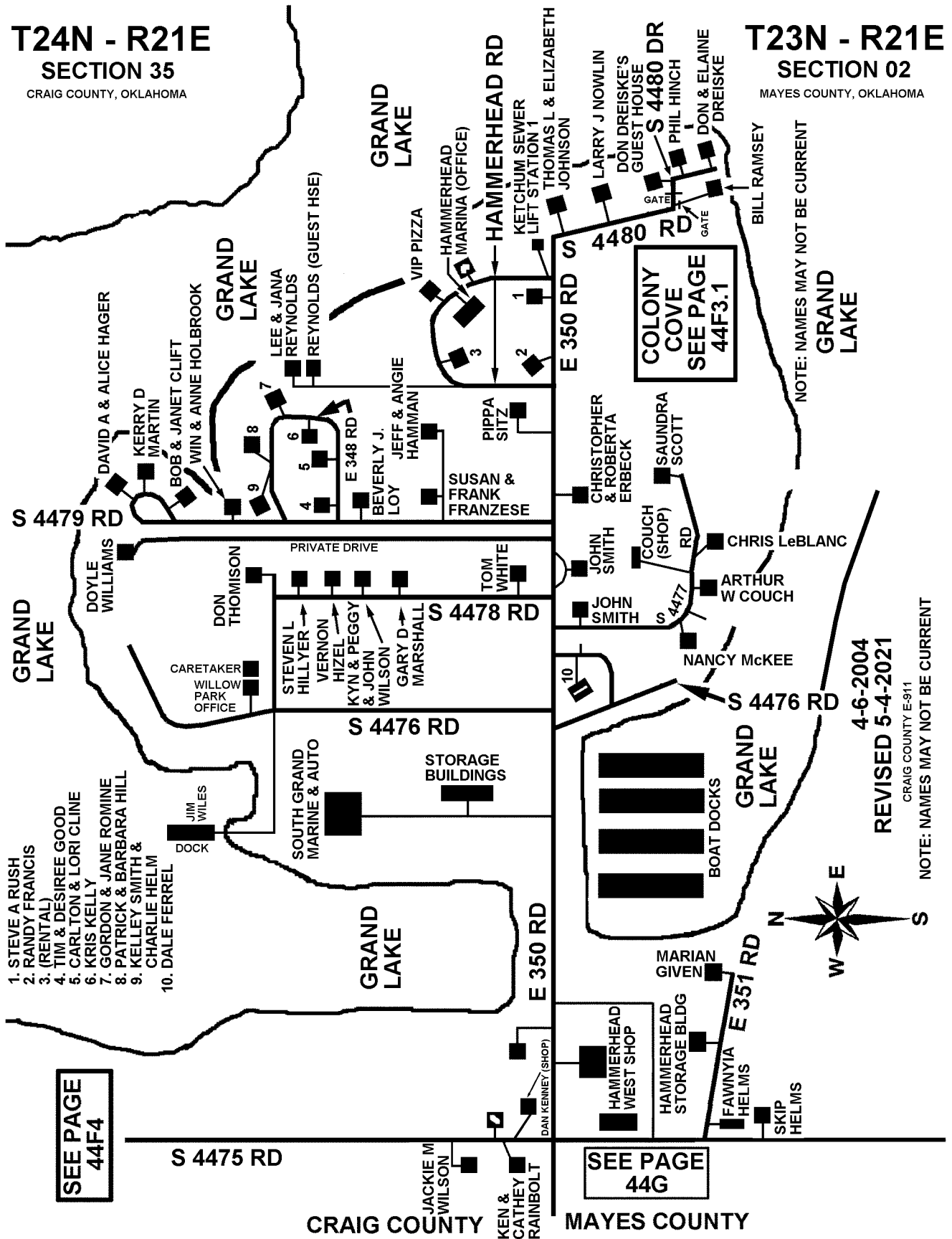

1. STEVE A RUSH
2. RANDY FRANCIS
3. (RENTAL)
4. TIM & DESIREE GOOD
5. CARLTON & LORI CLINE
6. KRIS KELLY
7. GORDON & JANE ROMINE
8. PATRICK & BARBARA HILL
9. KELLEY SMITH & CHARLIE HELM
10. DALE FERREL

SEE PAGE
44F4

SEE PAGE
44G

NOTE: NAMES MAY NOT BE CURRENT

NOTE: NAMES MAY NOT BE CURRENT

4-6-2004
REVISED 5-4-2021
CRAIG COUNTY E-911