

T22E - R24N

SECTION 23

DELAWARE COUNTY, OKLAHOMA

AMBER WAVES ADDITON

SEE PAGE 45A4.4

WOODLAND SHORES

SEMINOLE AVE

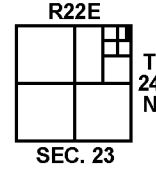

SEE PAGE 45A4.10

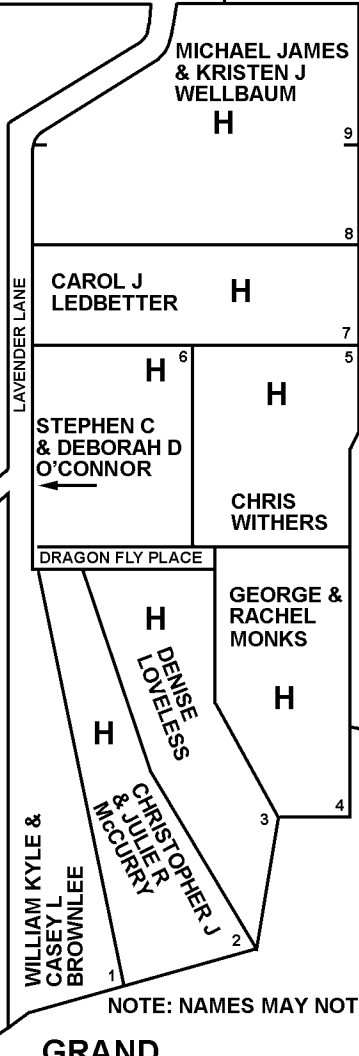

SEE PAGE 45A4.7

NOTE: NAMES MAY NOT BE CURRENT

GRAND LAKE

GRAND LAKE

1-27-2006  
REVISED 6-19-2018  
CRAIG COUNTY E-911