

THE POINTS

45D

T23N - R21E
SECTION 01
MAYES COUNTY, OKLAHOMA

T23N -R22
SECTION 06
DELAWARE COUNTY, OKLAHOMA

SEE PAGE
45J

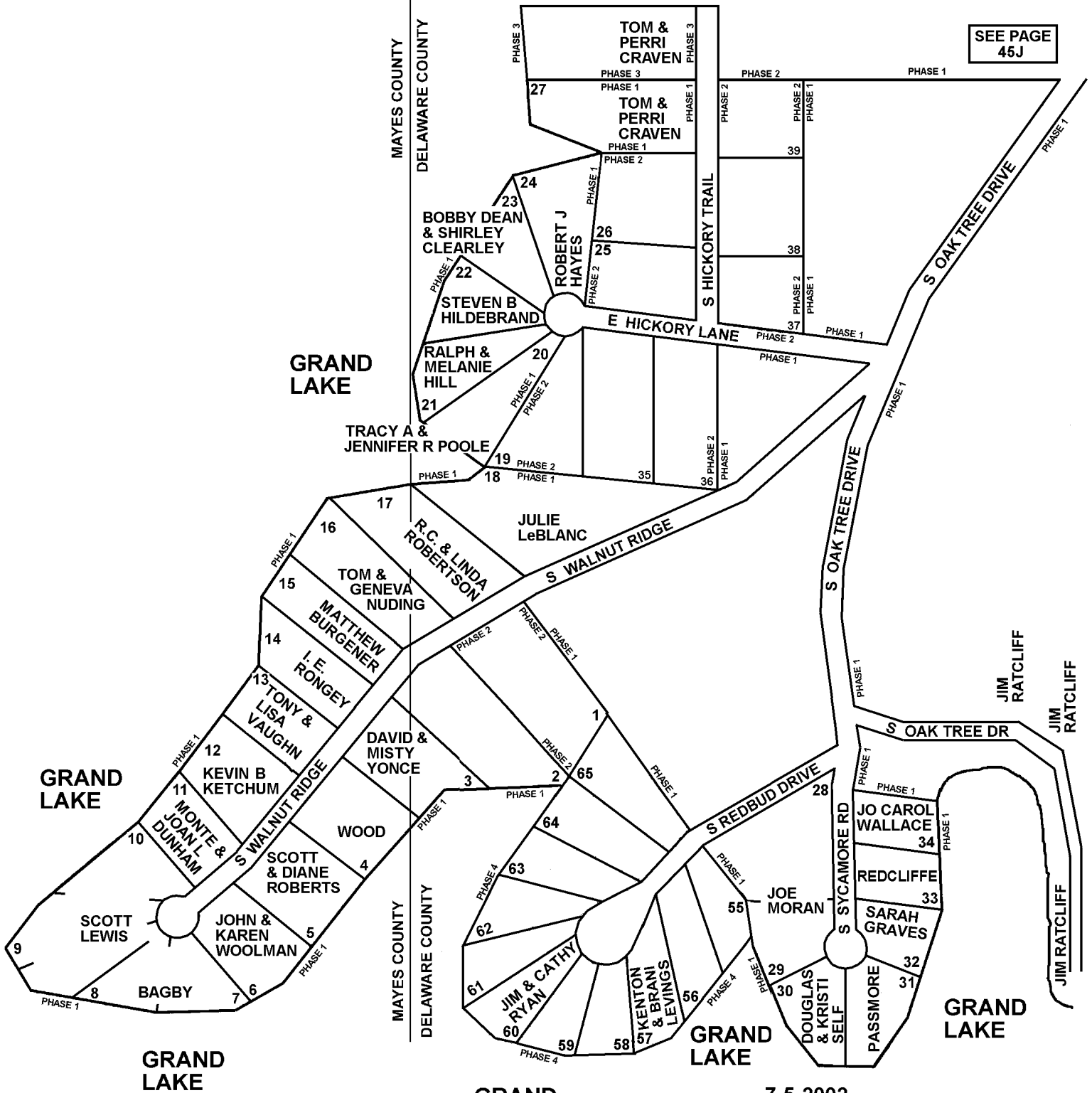

GRAND LAKE

7-5-2002
REVISED 7-22-2021
CRAIG COUNTY E-911

NOTE: NAMES MAY NOT BE CURRENT