

T24N - R22E

SECTION 21

DELAWARE COUNTY, OKLAHOMA
CHEROKEE YACHT CLUB 1
DEER COVE ESTATES

45H3

LUSK
CIRCLE

SEE PAGE
45H2

BERRYMAN TURN

FIRE
DEPT



DUCK
CREEK

DUCK
CREEK

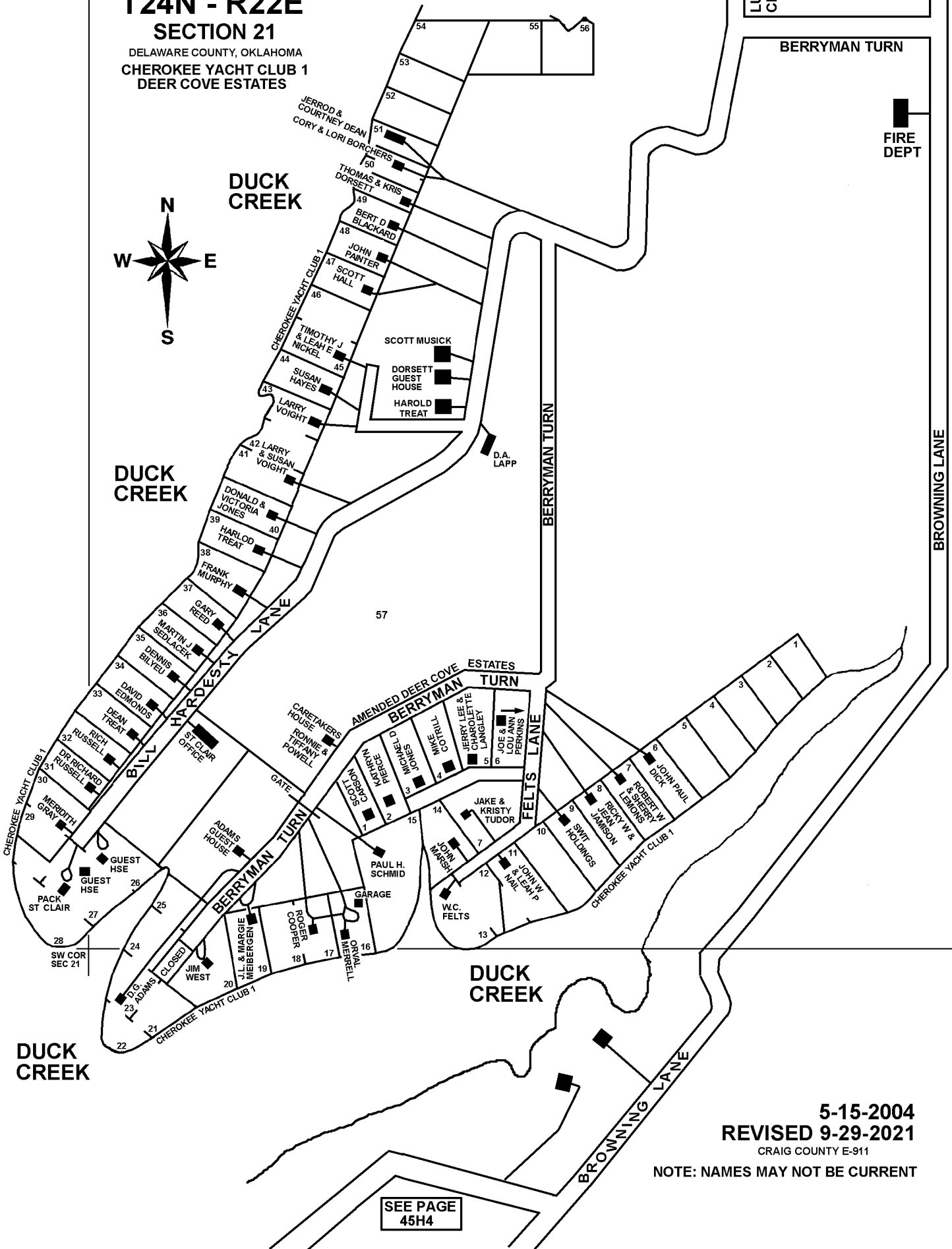

BROWNING LANE

DUCK
CREEK

DUCK
CREEK

5-15-2004
REVISED 9-29-2021
CRAIG COUNTY E-911

NOTE: NAMES MAY NOT BE CURRENT

SEE PAGE
45H4