

# T24N - R22E

## SECTION 28

DELAWARE COUNTY, OKLAHOMA

### CHEROKEE YACHT CLUB CHEROKEE YACHT CLUB CIRCLE BOGDON SUBDIVISION BOGDON SUB 1

SEE PAGE  
45H3

45H4

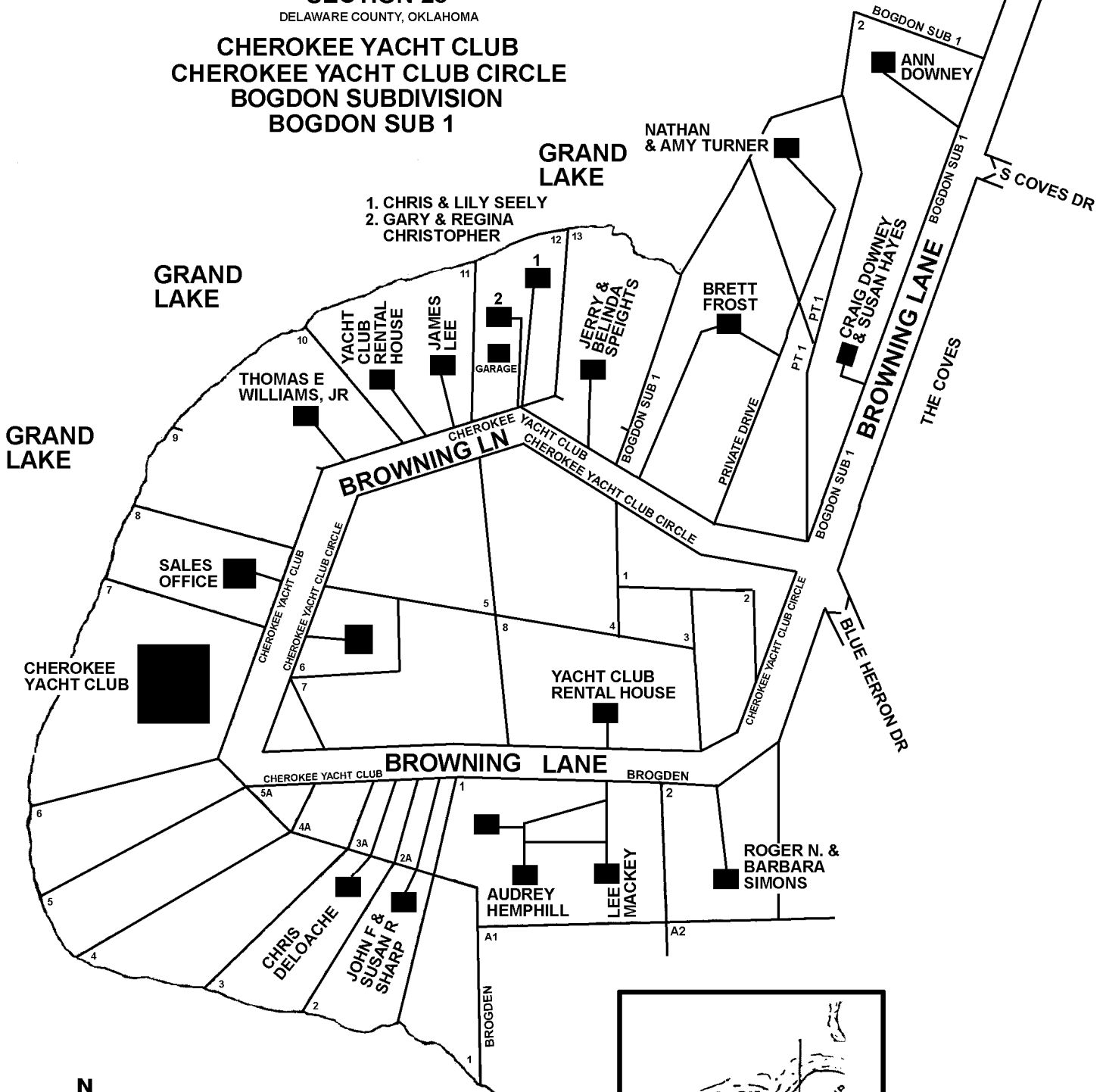

GRAND LAKE

5-15-2004  
REVISED 3-6-2018

CRAIG COUNTY E-911

NOTE: NAMES MAY NOT BE CURRENT

