

T24N - R22E

SECTION 22

DELAWARE COUNTY, OKLAHOMA

EAGLE BLUFF

45M

SEE PAGE 45

EAGLE BLUFF



RONALD D RYAN

EAGLE BLUFF DRIVE

GRAND LAKE

JOHN T & JULIE M NICKEL

GRAND LAKE

ROY LEE & JANIE FARLEY

GRAND LAKE

BOHANNAN FAMILY TRUST

EAGLE BLUFF DRIVE

GRAND LAKE

STEVEN L & HEIDI RENE HAYS

JANET & ARTHUR PHILLIPS

PAM HARTLEY

DON & PEGGY REESER

GERALD M BROTHER

1

S 4520 RD

EAGLE BLUFF LANE

CLOSED

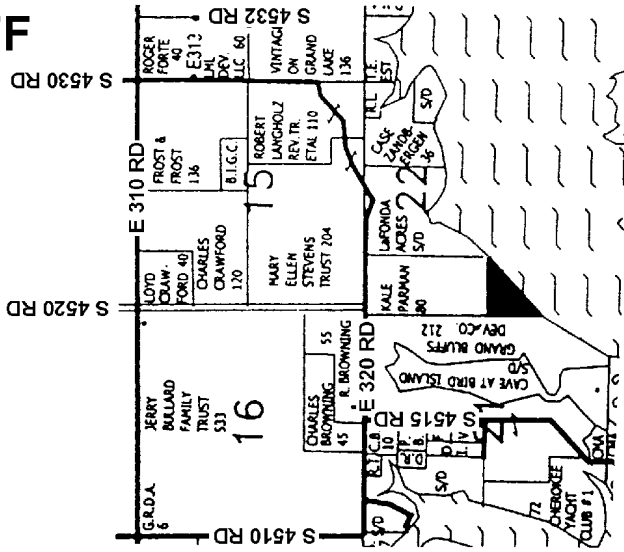

6-10-2002
REVISED 10-19-2016

CRAIG COUNTY E-911

NOTE: NAMES MAY NOT BE CURRENT